

Gearbox - Removal & Installation

PREPARATION:

Remove Power Brush and drive belt from Power Unit. This will ease access to the gearbox assembly and rear chain drive. Follow the instructions to replace the gearbox on the Power Brush. Use the instructions in reverse order to install the gearbox assembly.

1. Remove both springs from idler sprocket to bolts on the housing. This will ease access to the removal of the drive chain.

2. Remove pop rivets and shield from housing.

NOTE: It is important the chain stays in place for easier installation.

3. Turn chain until connector link can be seen from this side. Remove connector link and chain from gearbox sprocket. Secure chain ends to housing. Do not remove chain. Note chain routing, refer to Figure - Side View.

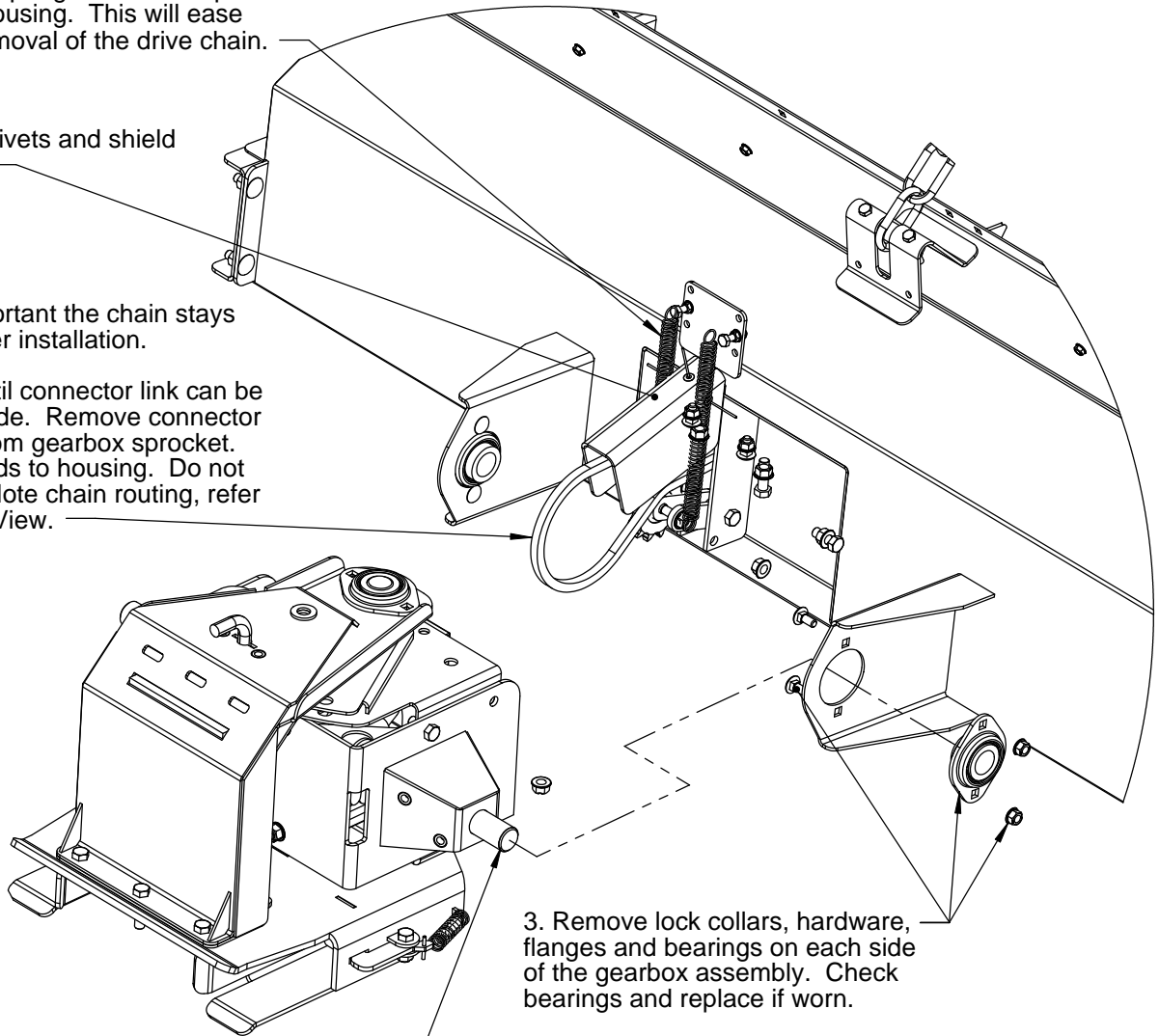

3. Remove lock collars, hardware, flanges and bearings on each side of the gearbox assembly. Check bearings and replace if worn.

NOTE: Secure a hoist to the gearbox to ease removal.

4. Move gearbox from side to side so shafts clear the mounting brackets. Remove gearbox assembly.

Figure - Side View, Chain Routing

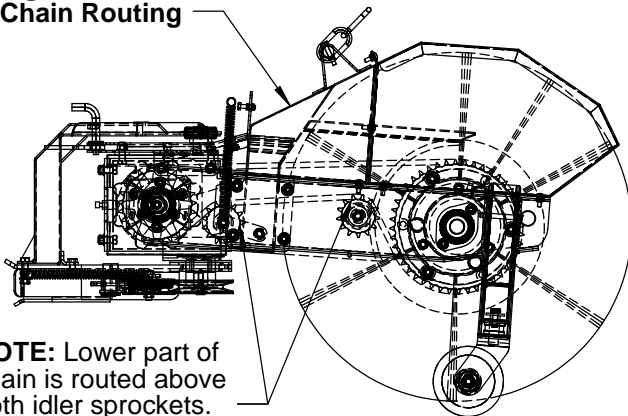

NOTE: Lower part of chain is routed above both idler sprockets.